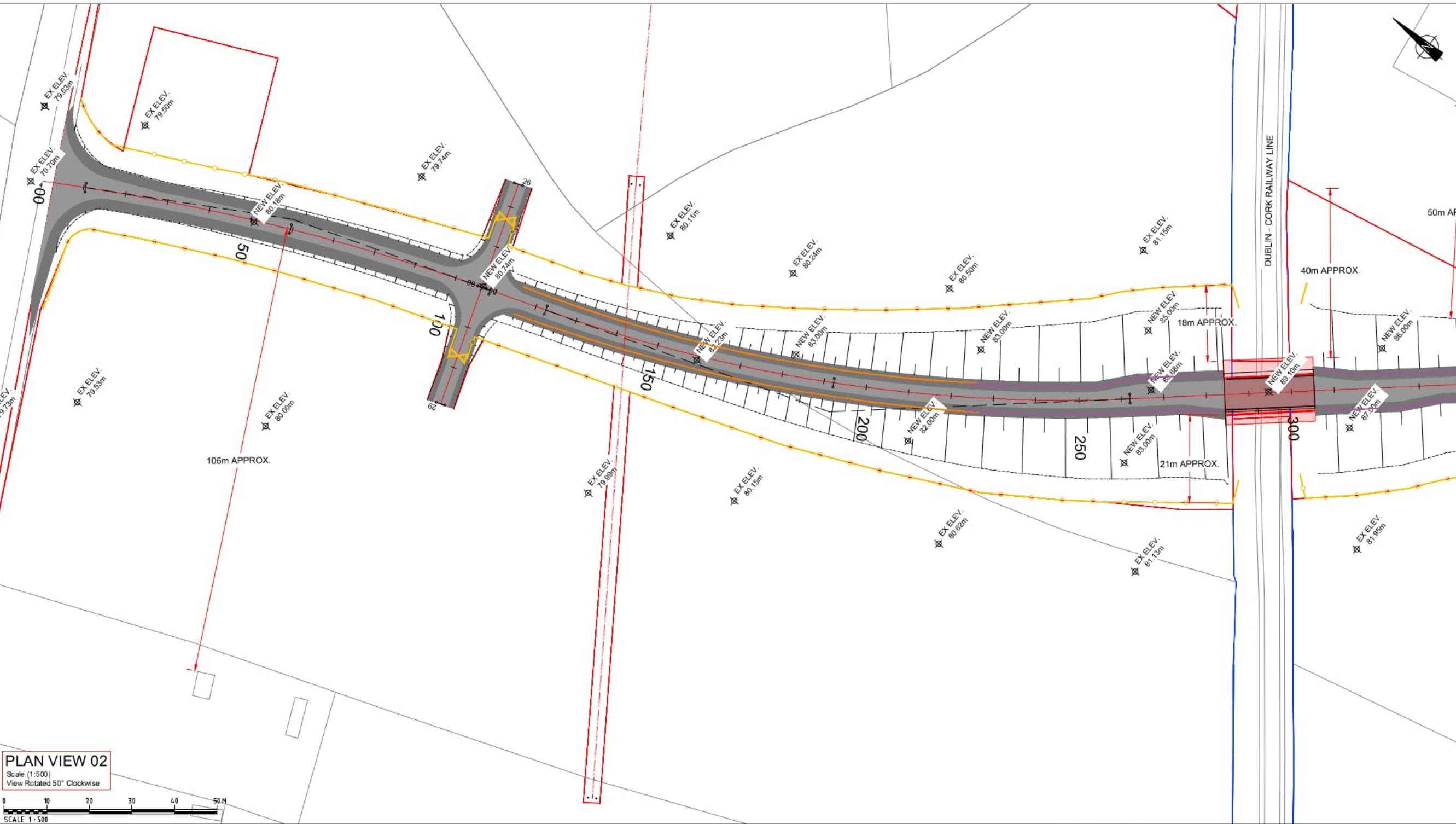
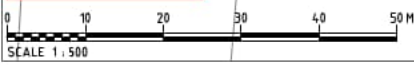

**FIGURE 3C  
XC201 - THOMASTOWN**

NOTES:  
1. ALL DIMENSIONS ARE IN METRES UNLESS OTHERWISE STATED

**PLAN VIEW 01**  
Scale (1:500)  
View Rotated 330° Clockwise



**PLAN VIEW 02**  
Scale (1:500)  
View Rotated 50° Clockwise

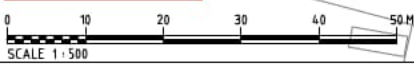

**LEGEND**

- PROPOSED ROAD ALIGNMENT
- PROPOSED FOOTWAY PAVEMENT
- PROPOSED STRUCTURE
- WAYLEAVE - RIGHT OF WAY
- RED LINE BOUNDARY
- IRISH RAIL LAND OWNERSHIP
- PROPOSED SAFETY BARRIER
- PROPOSED PEDESTRIAN GUARDRAIL
- PROPOSED FENCELINE
- PROPOSED GATE
- MASONRY WALL
- PROPOSED MASONRY WALL
- IR BARRIER
- EXISTING IR BARRIER
- PALISADE GATE
- PALISADE GATE

**DRAWING PREPARED BY:**

NAME: JOHN ROCKS  
 COMPANY: JACOBS ENGINEERING UK LTD.  
 ADDRESS: SECOND FLOOR, ROCHESTER BUILDING, 28 ADELAIDE STREET, BELFAST

**LOCATION PLAN**



Rev	By	Date	Description
0	JR	OCT '20	DRAFT ISSUE FOR COMMENT
1	AB	DEC '20	SITE NOTICES REMOVED

Project:	CORK LINE LEVEL CROSSINGS
Component:	RAILWAY ORDER SCHEDULE DRAWING
Title:	PROPOSED SITE PLAN - XC201 THOMASTOWN - SHEET 1 OF 2
Design:	SK
Drawn:	JR
Checked:	FMD
Original scale:	PLAN 1:500 @ A1
Date:	DEC '20
Drawing No.:	32111000-JAC-LUX-XC201-DR-CH-004(I)